

Custom Pediatric Services For Children Birth to 18.

PHYSICAL THERAPY

Specialists in gross motor development work closely with children using a range of hands-on techniques and activities designed to improve skills and maximize a child's functional potential.

Specialties also include:

- Dynamic Ankle Foot Orthotic (DAFO) Casting
- Serial Casting
- Therapeutic Electrical Stimulation (Certified PTs for Cerebral Palsy)
- Aquatic Therapy

OCCUPATIONAL THERAPY

To promote independence with life skills through assessment of self-care tasks, fine motor and visual motor/perceptual skills, our specialists use leading therapeutic techniques and technology to maximize a child's function in the home, school and community. Specialties also include:

- Sensory Integrative Therapy (Autism Spectrum Disorders, ADD/ADHD, Motor Planning)
- Splinting/Serial Casting
- Complex medical diagnoses such as extreme prematurity, orthopedic and neurological conditions
- Cognitive/Psychosocial Assessment

SPEECH LANGUAGE THERAPY

Children with oral-motor, feeding and pre-speech deficits as well as speech/language impairments are given a care program that promotes progress and encouragement from



certified speech therapists. Specialties also include:

- Oral-motor feeding disorders including breastfeeding
- Language disorders including autism, auditory and language processing deficits
- Oral and verbal apraxia
- Augmentative communication

Co-treatments providing a team approach are available depending on the needs of the child or family.

To initiate therapy services, families need to request a referral from their physician. Our office will contact you to schedule an appointment that will accommodate your child's and family's needs and schedule.

Joint Clinics with SIU School of Medicine include:

- Augmentative Communication Clinic
- Children's Diagnostic Clinic
- Feeding Team
- Neonatal Intensive Care Unit (NICU) Follow-up Clinic
- Wheelchair/Adaptive Equipment Clinic
- Neuromotor Clinic

Registration

On your first appointment, please register at the Outpatient Admitting Desk located inside the main entrance of the Carol Jo Vecchie Women & Children's Center. Please allow at least 20 minutes for registration. Escort service to the Rehabilitation Department is available.

Location

Physical, Occupational and Speech Language Therapy — Pediatric Rehabilitation, main floor of the Carol Jo Vecchie Women & Children's Center at St. John's Hospital.

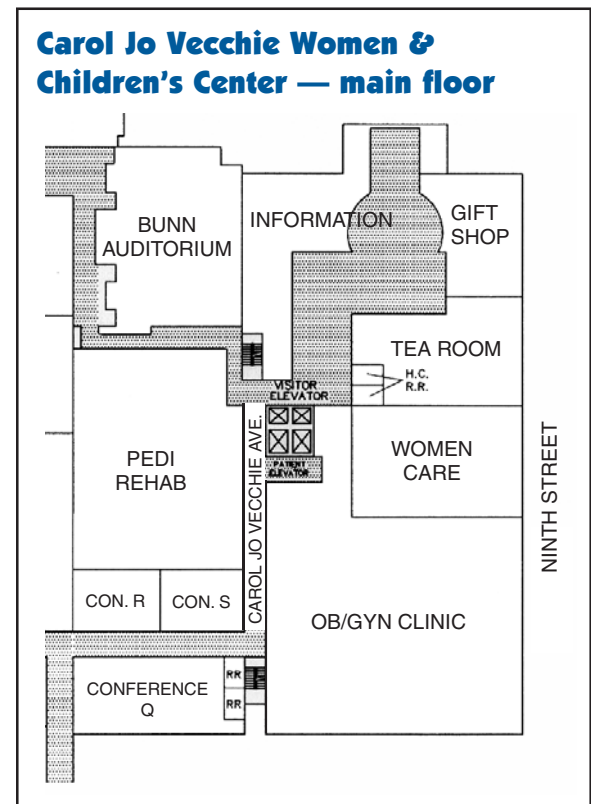
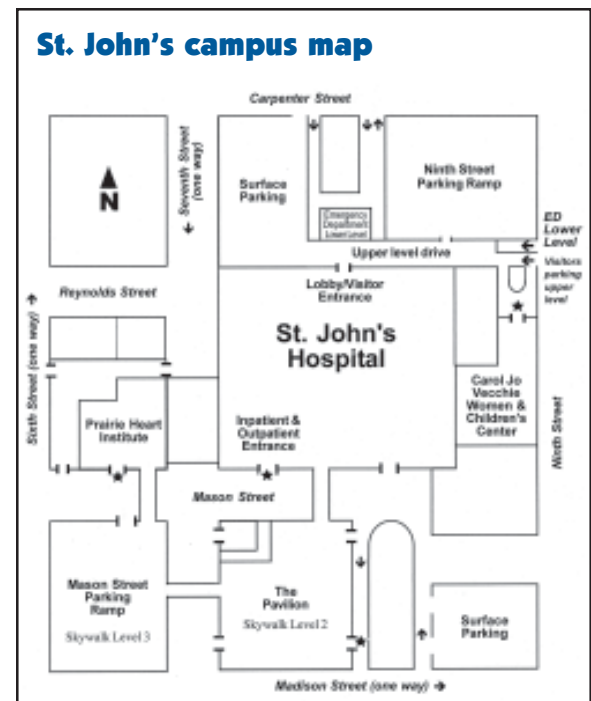
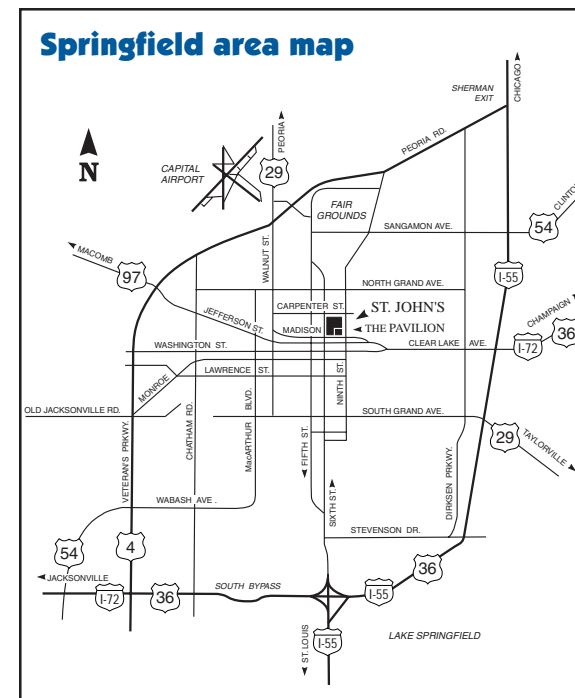

Parking

Parking is available in the ramp located at Ninth and Carpenter streets. Free valet parking is available at the entrance.

Billing

Billing is handled through our Business Office. Please call ext. 55615 for assistance.

Questions Concerning Your Child's Therapy?

If you have any comments, concerns or questions, discuss them with the Pediatric Rehabilitation team or contact the supervisor of Pediatric Rehab at (217) 544-6464, ext. 30200.



 **St. John's Children's Hospital**
Carol Jo Vecchie Women & Children's Center

800 East Carpenter Street
Springfield, IL 62769
(217) 544-6464, ext. 30200
www.st-johns.org



PEDIATRIC REHABILITATION
Just For Kids

 **St. John's Children's Hospital**
Carol Jo Vecchie Women & Children's Center

A Special Place For Kids That Hold A Special Place In Your Heart.

Our Pediatric Rehabilitation care program is designed just for kids

as children are physically, emotionally and intellectually different from adults. They need special care that takes into consideration their special needs, from smaller furniture to kid-sized therapy equipment. At St. John's Pediatric Rehabilitation,



we are able to suit every child's needs.

But more important is our expertise and

success in working with kids to reach their full potential. Every

child is assigned a rehabilitation team experienced in treating

kids and their families.  Your team will develop a tailor-

made rehabilitation program, just for your child. As Pediatric

Rehabilitation specialists, we understand that each child is wonderfully different and so are their care requirements.

 As the region's designated Children's Hospital, we have access to

the latest treatment techniques, technology and innovative ap-

proaches. We also collaborate with Southern Illinois University

School of Medicine, making our Pediatric Rehabilitation care

program the recognized regional leader.

